



# Horley Road, Mottingham, SE9

Guide Price £400,000

🛏️ 2 🚿 1 🚗 1



- Wonderful Two Bedroom House
- Recently Refurbished Throughout
- Extended Conservatory
- Large Garden To Rear
- Off Street Parking
- Walking Distance To Railway Links
- Local Shops, Amenities & Leisure Facilities Within Easy Reach
- Excellent Bus Links Nearby
- Ideal For First Time Buyers Or Buy To Let Investors
- Council Tax Band C - London Borough Of Bromley



**\*\*\* GUIDE PRICE £400,000 - £425,000 \*\*\***

Cockburn are excited to present this recently refurbished, bright and spacious two-bedroom family home - An ideal opportunity for first-time buyers or buy-to-let investors alike.



Horley Road, London, SE9  
 Approximate Area = 710 sq ft / 66 sq m  
 For information only - not to scale

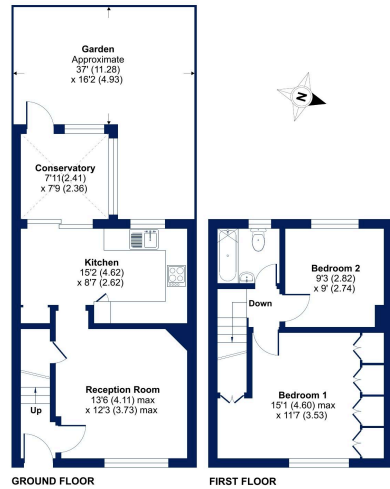

© Cockburn EA  
 Floor plan produced in accordance with RICS Property Measurement Standards incorporating International Property Measurement Standards (IPMS) (London). © Cockburn 2024.  
 Prepared for Cockburn Estate Agents. 1001 - 11/2024

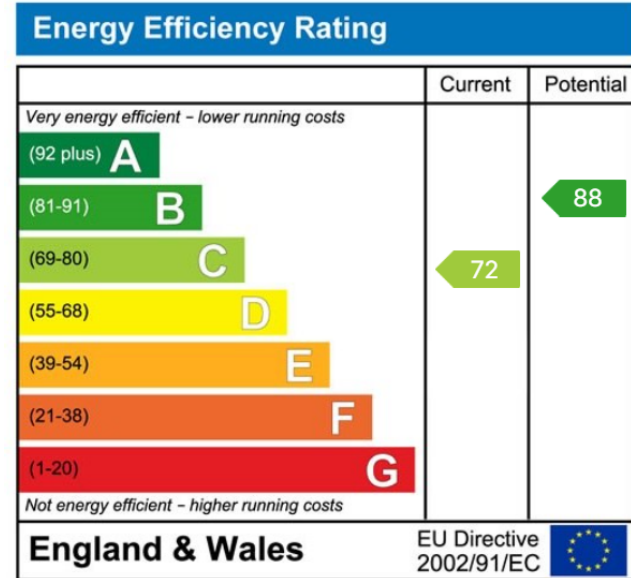

**Cockburn EA**

352 Footscray Road,  
 London, SE9 2EB

t: 020 8859 8590